

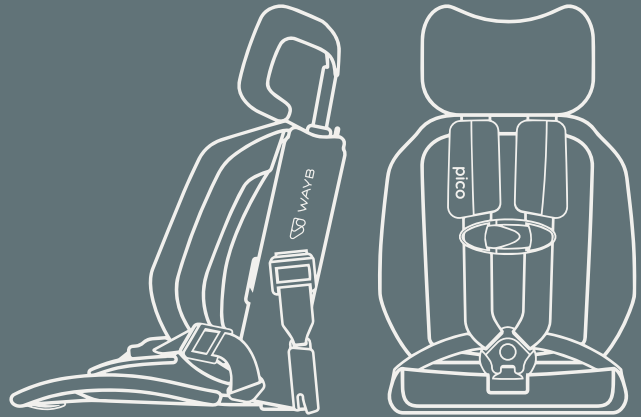

WAYB



Meet your Pico™

ADVENTURES AWAIT



Forward-Facing Car Seat

For kids 22 to 50 lbs. (10 to 22.7 kg) / 30 to 45 in. (76 to 114 cm)



TABLE OF CONTENTS

Read all instructions before use of this Forward-Facing Car Seat.
Keep Instruction Manual for future use.

GOOD TO KNOW

Certification	2
Assistance	2
Who Can Use It	2
Registering Your Pico	3
Pico Useful Life	3
Warm Weather Information	4
Warnings and General Safety Info	4

MEET PICO

Pico Parts Overview	6
Pico Specifications	8

GET READY

Choosing a Vehicle Seating Position	9
LATCH System Overview	10
Vehicle Seat Belt System Overview	11
Unsafe Vehicle Seat Belt Systems	16

GET SET

Setting Up Pico	17
Two Ways to Secure Pico	19
Folding Pico for Transport or Storage	20

TABLE OF CONTENTS

GO!

LATCH Installation	22
Removal of Pico Installed with LATCH	27
Vehicle Seat Belt Installation	29
Removal of Pico Installed with Vehicle Seat Belt	33
Aircraft Installation	34

SNUG AND SECURE

Securing Child in Pico	35
Removal of Child from Pico	39
Buckle Operation	40
Harness Strap Adjustment	40
Chest Clip Operation	41
Shoulder Pad Removal and Installation	42
Headrest Adjustment	43

TAKE CARE

Care and Cleaning	43
Fabric Pad Removal and Installation	44
Car Seat Use After a Crash	47
Breathe Easy Guarantee	48

Para instrucciones en Español, llamar al: 888-924-WAYB (9292),
visita la página www.wayb.com o envía un correo a help@wayb.com



CERTIFICATION



This car seat meets or exceeds all applicable requirements of Federal Motor Vehicle Safety Standard 213 for use in motor vehicles and aircraft.

ASSISTANCE

Contact WAYB at **1-888-924-WAYB** (9292), visit WAYB's Contact and FAQ page at www.wayb.com, email help@wayb.com or use one of the following resources:

- Call **1-866-SEAT CHECK** (1-866-732-8243).
- Go to www.nhtsa.gov.
 - Click on "Child Safety".
 - For a car seat inspection station use "Child Safety Seat/Inspection Station Locator".
- Go to onto www.seatcheck.org.

WHO CAN USE IT

This child restraint is designed for use only by children whose:

- Weight is between 22 lbs. and 50 lbs. (10 and 22.7 kg).
- Height is between 30 in. and 45 in. (76 cm and 114 cm).
- Shoulders are below top of seat back.
- Minimum age is 1 year. WAYB recommends children be at least 2 years of age before using this forward-facing restraint.

⚠ WARNING ⚠

- To avoid injuries from whiplash, top of child's ears **MUST** be below top of headrest.
- Discontinue use of car seat if child's shoulders are above top of seat back or top of ears are above top of headrest in its highest use position or child's weight exceeds 50 lbs (22.7 kg).

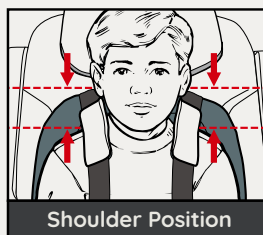
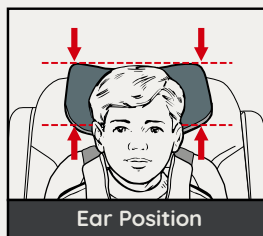

REGISTERING YOUR PICO

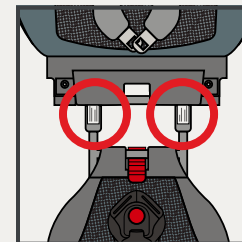

Child restraints could be recalled for safety reasons. You must register this restraint to be reached in a recall. Send your name, address, email address if available, and the restraint's model number and manufacturing date to:

- **WAYB**
99 Pasadena Avenue, Suite 11
South Pasadena, CA 91030
- or -
- Call: **1-888-924-WAYB** (9292)
- or -
- Register online at www.wayb.com/pages/register



Register online at www.wayb.com/pages/register. Point your smartphone's camera directly at the QR Code to activate.

For recall information:

- Call the U.S Government's Vehicle Safety Hotline at **1-888-327-4236** (TTY: 1-800-424-9153) or go to <http://www.NHTSA.gov>.
- Go to the National Highway Traffic Safety Administration recall website at www.safercar.gov and follow links to Child Restraint Recalls.

PICO USEFUL LIFE

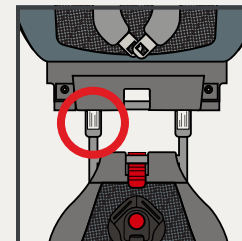

DO NOT use after seven (7) years from date of manufacture provided on car seat label.



WARM WEATHER INFORMATION

Car seat parts can get very hot in the sun or warm weather. To avoid burns, always check before putting child in car seat.

WARNINGS AND GENERAL SAFETY INFO



WARNING DEATH OR SERIOUS INJURY CAN OCCUR



- Failure to follow the instructions provided in this manual and on the car seat labels can result in injury or death to a child during a sudden stop or crash.
- Use only with children who weigh between 22 lbs. and 50 lbs. (10 kg and 22.7 kg) and whose height is between 30 in. and 45 in. (76 cm and 114 cm).
- Children **MUST** be more than 1 year of age and at least 22 lbs. (10 kg). WAYB recommends children be at least 2 years of age before using this forward-facing car seat.
- Discontinue use of car seat if child's shoulders are above top of seat back or top of ears are above top of headrest in its highest use position or child's weight exceeds 50 lbs (22.7 kg).
- Snugly adjust the belts provided with this child restraint around your child.
- Secure this child restraint with the vehicle's child restraint anchorage system, if available, or with a vehicle's seat belt.
- LATCH System or vehicle seat belt **MUST** stay tightly adjusted around car seat at all times.
- Secure the tether strap provided with this child restraint as specified in this instruction manual.



WARNING DEATH OR SERIOUS INJURY CAN OCCUR



- Securely belt this car seat in vehicle, even when not occupied. An unsecured car seat can injure other occupants in a crash.
- **NEVER** leave child unattended, even when sleeping. Vehicle interiors can very quickly get hot enough to cause severe injury or death, even when it is not hot outside.
- Strangulation Hazard: Child can strangle in loose harness straps. **NEVER** leave child in car seat when straps are loose or unbuckled.
- **DO NOT** use accessories or parts other than those approved by WAYB. Use of unapproved accessories or parts could degrade the performance of the car seat. Go to the FAQ section of www.wayb.com to find approved list of accessories.
- **DO NOT** allow any re-use of this car seat after a crash unless crash and car seat meet **ALL** conditions in the "Car Seat Use After a Crash" section of this manual (pg. 47).
- **DO NOT** use this car seat if it is damaged, missing instructions, or missing parts.
- **DO NOT** use this car seat after seven (7) years from date of manufacture. Date of manufacture can be found on label on bottom of car seat. See the "Pico Useful Life" section of this manual for assistance (pg. 3).
- You **MUST** register your child restraint to be reached in the event of a recall. Register your child restraint with manufacturer and see the "Registering Your Pico" section of this manual for assistance (pg. 3).
- **NEVER** use without **ALL** fabric pads in place.
- **ALWAYS** store tether and push-on LATCH connectors when not in use.
- **DO NOT** use this car seat in a low speed vehicle (LSV), low speed vehicles **DO NOT** meet the same standards as passenger cars.



PICO PARTS OVERVIEW

- 1. Backrest
- 2. Shoulder Strap Pads
- 3. Chest Clip
- 4. Shoulder Straps
- 5. Buckle Tongues
- 6. Buckle
- 7. Hip Straps
- 8. Buckle Strap
- 9. Headrest
- 10. Lap Belt Guide
- 11. Seat Bottom
- 12. Buckle Pad
- 13. Fold Release

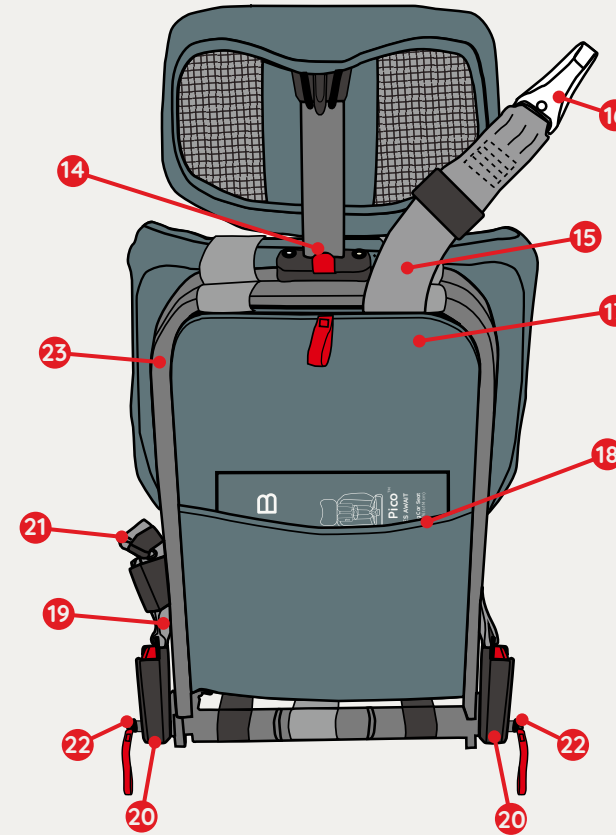
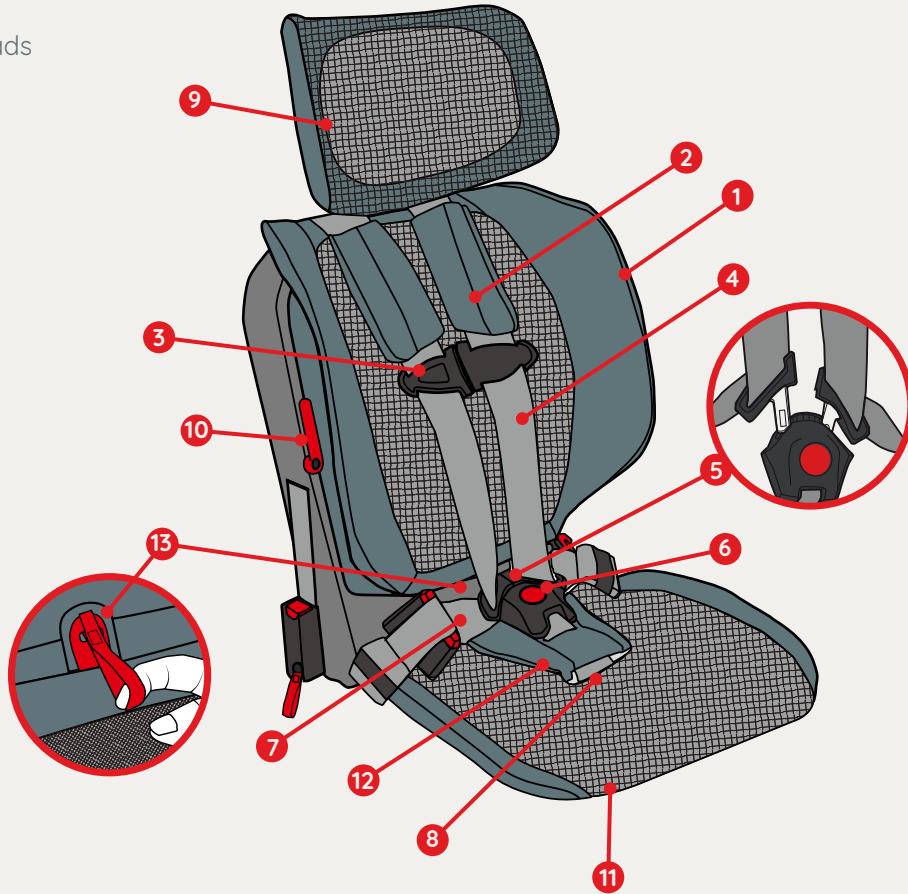

- 14. Headrest Adjustment Button
- 15. Tether Strap
- 16. Tether Hook
- 17. Tether Storage Pocket
- 18. Instruction Manual Storage Pocket
- 19. Lower Anchor Belt (LATCH)
- 20. Push-On Connector (LATCH)
- 21. Lower Anchor Belt Adjuster (LATCH)
- 22. Push-On Connector Storage Bar
- 23. Car Seat Frame



PICO SPECIFICATIONS

Dimensions

Storage Position: 11.6" L x 14.5" W x 18.9" H

Lowest Headrest Position: 15.2" L x 14.5" W x 22.8" H

Highest Headrest Position: 15.2" L x 14.5" W x 27.8" H

Weight

Car Seat Weight: 8.0 lbs

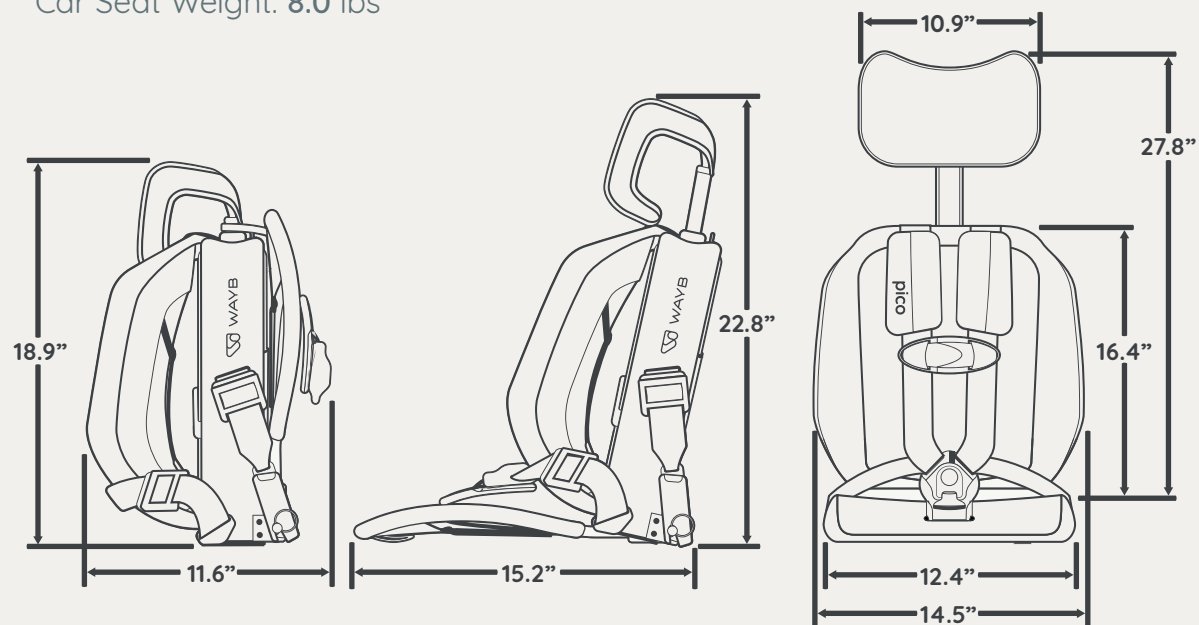

CHOOSING A VEHICLE SEATING POSITION

⚠ WARNING ⚠

The National Highway Traffic Safety Administration (NHTSA) alerts vehicle owners that according to crash statistics, children 12 years and younger are safer when properly restrained in the rear seating positions rather than the front seating positions.

- Use car seat in a rear vehicle seat location whenever possible.
- **NEVER** use a car seat in a front seat location unless recommended in vehicle owner's manual.
- For vehicles with air bags, always follow child restraint installation information provided in vehicle owner's manual.

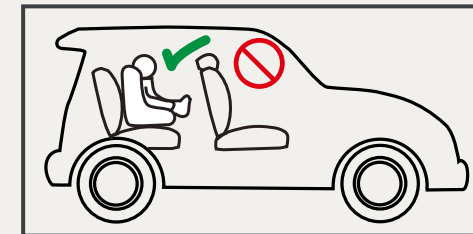

If a vehicle front seat location with an air bag must be used, follow the vehicle manufacturer's instructions for child restraint use and move the vehicle seat back as far as possible.

DO NOT use this car seat on the following types of vehicle seats:

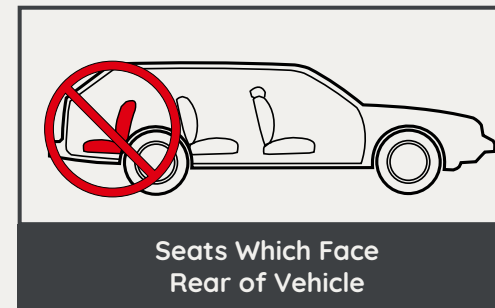



LATCH SYSTEM OVERVIEW

LATCH SYSTEM ON THIS CAR SEAT

The LATCH System on the Pico consists of a lower anchor belt **1** with push-on connectors **2** and a tether strap **3** with tether hook **4**.

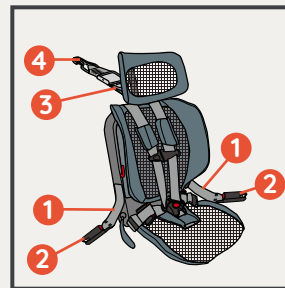

LATCH ANCHORAGE SYSTEM IN VEHICLES

Child restraint anchorage system or LATCH System in the vehicle consists of two lower anchors **5** located at the vehicle seat bight **6** and a tether anchor **7**. Refer to vehicle owner's manual for seating locations which have the LATCH Anchorage System.

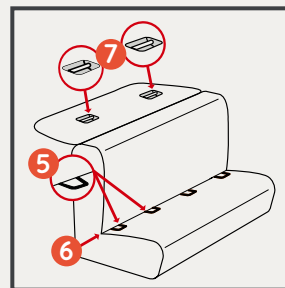

Information regarding the LATCH System may be identified by the LATCH System symbol.



Lower anchors may not be visible in some vehicles. Lower anchors that are not visible may be located below a solid color round dot on the vehicle upholstery or a round dot with a picture of a car seat in the center as shown.

The vehicle manufacturer may provide funnel guides to separate the vehicle seat cushions providing easier access to the lower anchorages. See vehicle owner's manual.



Tether anchors may be marked with this symbol.

VEHICLE SEAT BELT SYSTEM OVERVIEW

⚠ WARNING ⚠

- Not all vehicle seat belts can be used with a car seat. The car seat **MUST** be held tightly at all times by a lap belt (or lap belt portion of a lap/shoulder belt) that will not loosen while driving.
- If vehicle seat belt does not stay tightly adjusted after following all instructions in your vehicle owner's manual and this section, try another vehicle seating location or install with LATCH.

WAYB strongly recommends installing the Pico with LATCH whenever it is possible to correctly install with LATCH. The LATCH system generally allows for the easiest installation.

Design and operation of vehicle seat belt systems vary from vehicle to vehicle and from seating location to seating location in the same vehicle. Not all vehicle seat belts can be used with a child restraint.

Read this section and check your vehicle owner's manual for information about what type of vehicle belts your vehicle has and if they can or cannot be safely used with this car seat.

TO PROVIDE A SECURE INSTALLATION OF THE CAR SEAT

Read the vehicle owner's manual regarding securing a car seat and vehicle seat belt use with car seat. Follow all instructions in your vehicle owner's manual, this manual and the labels on car seat. If car seat does not stay tightly secured after following instructions in this manual and in your vehicle owner's manual:

- Move car seat to another seating location and try again, or install with LATCH.
- Contact vehicle dealer for assistance and seat belt modification parts, when available.
- See the "Assistance" section of this manual (pg. 2).

VEHICLE BELTS THAT MAY BE USED WITH THIS CAR SEAT

Any of the following belt types may be used to install this car seat as long as a secure installation can be achieved, the vehicle belt stays tightly adjusted and the seating position and vehicle belts are approved for installation of a car seat in the vehicle owner's manual.

See "Vehicle Seat Belt Installation" section for installation instructions (pg. 29).

COMBINATION LAP & SHOULDER BELT WITH FREE SLIDING LATCH PLATE

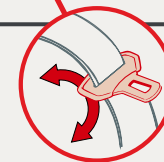
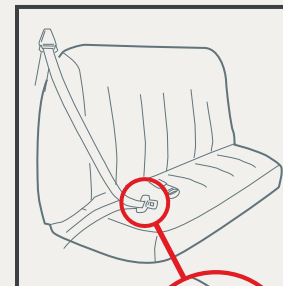

Most lap & shoulder belts with free sliding latch plate have switchable retractors.

- Gently pull the shoulder belt out until it stops.
- Gently let the shoulder belt retract about 6 in. (15 mm).
- Pull back out on the shoulder belt.

If the shoulder belt is locked and does not pull out, then you have a switchable or automatic retractor which can be used with this car seat.

Retractor **MUST** always be switched to locking mode when tightening vehicle belt to secure Pico.

NOTE: If the belt pulls out, the retractor is an emergency locking retractor which can be used to install car seat but **MUST** be used with a locking clip. Please contact WAYB at **1-888-924-WAYB** (9292) or email help@wayb.com to request a free locking clip.

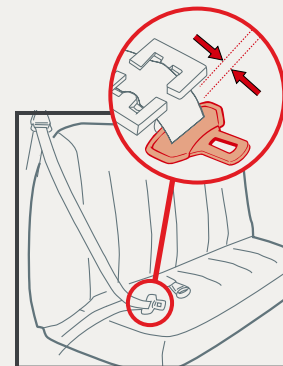

TO USE LOCKING CLIP

1. Install car seat and tighten vehicle seat belt.
2. Hold vehicle seat belts together at latch plate and unbuckle.
3. Slide locking clip on seat belts approximately 1 in. (2.5 cm) away from latch plate.
4. Re-buckle seat belt.
5. Retest for secure installation and verify that lap belt stays tight.

NOTE: Call **1-888-924-WAYB** (9292) or email help@wayb.com to request a free locking clip.



COMBINATION LAP & SHOULDER BELT WITH LOCKING LATCH PLATE

Vehicle seat belts with locking latch plates normally hold a car seat tightly. However, in some cases the locking latch plate on some seat belts may slip and loosen after being buckled on a car seat if positioned at a certain angle. If this happens, flip the latch plate over and re-buckle. Test installation again to see if this works. If not, move car seat to another seating location.

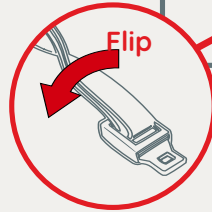
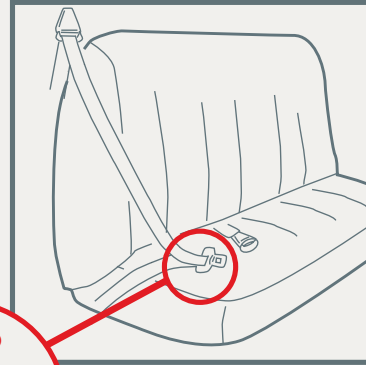

MANUALLY ADJUSTABLE LAP BELTS

Manually adjustable lap belts normally will hold a car seat tightly. In some cases, the locking latch plate on some seat belts may slip and loosen if positioned at a certain angle. If this happens, flip latch plate over and re-buckle.

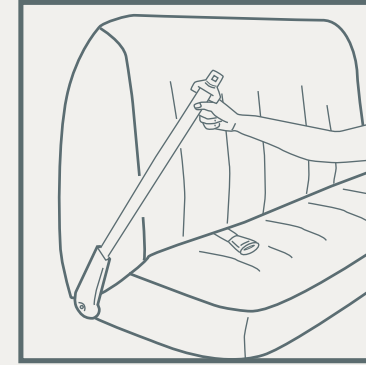
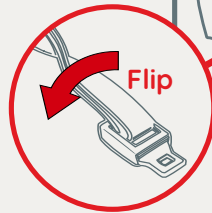
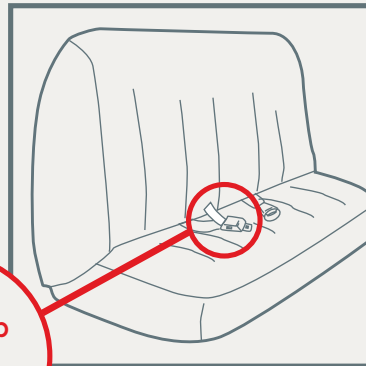

LAP BELTS WITH RETRACTOR

Lap belts with retractors may or may not hold a car seat securely.

- Gently pull the lap belt out until it stops.
- Gently let the lap belt retract about 6 in. (15 mm).
- Pull back out on the lap belt.

If the lap belt is locked and does not pull out, then you have a switchable or automatic retractor which can be used with this car seat.

Retractor **MUST** always be switched to locking mode when tightening vehicle belt to secure Pico.

NOTE: If the belt pulls out, the retractor is an emergency locking retractor which can be used to install car seat but **MUST** be used with a belt shortening clip.

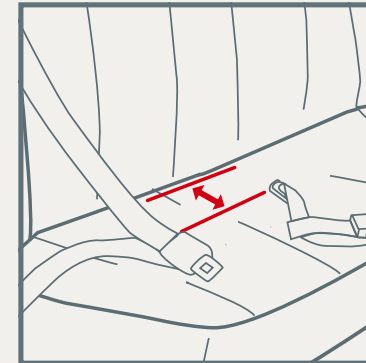

BELTS FORWARD OF SEAT BIGHT

Vehicle seat belts located forward of seat bight may not securely hold car seat. Check vehicle owner's manual or see vehicle dealer for car seat installation requirements.



UNSAFE VEHICLE SEAT BELT SYSTEMS

NEVER USE ANY OF THE FOLLOWING VEHICLE BELT TYPES TO INSTALL THIS CAR SEAT:

INFLATABLE SEAT BELTS

Some inflatable seat belts are labeled as inflatable belts. Most inflatable belts are noticeably thicker than a normal seat belt. Check your vehicle owner's manual to see if your vehicle has inflatable belts. **NEVER** use this car seat with an inflatable vehicle belt.



MOTORIZED PASSIVE RESTRAINTS

Lap Belt with Motorized Shoulder Belt. **DO NOT** use with any car seat.

See your vehicle dealer for options for securing a child restraint in this location.

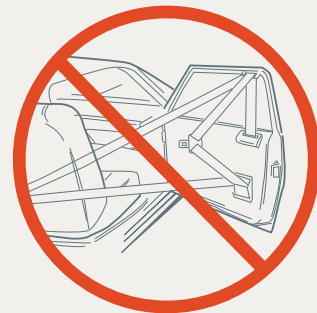

DOOR MOUNTED LAP OR SHOULDER BELT

DO NOT use with any car seat. Belts will not stay tight while driving.

See your vehicle dealer for options for securing a child restraint in this location.

SETTING UP PICO

⚠ WARNING ⚠

- Prevent pinching of child's fingers. Make sure seat bottom is locked in use position before placing child in seat.
- Headrest **MUST** be locked in a use position with headrest bottom above top of seat back before use.



Check out support videos at www.wayb.com/pages/support. Point your smartphone's camera directly at the QR Code to activate.

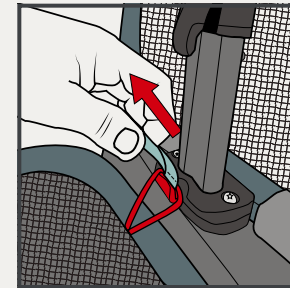

1. Release fold retention loop by pulling up on webbing pull tab.

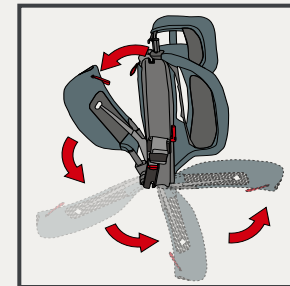

2. Rotate seat bottom from stored to use position.



SETTING UP PICO

3. Lock seat bottom in use position by closing fold release.

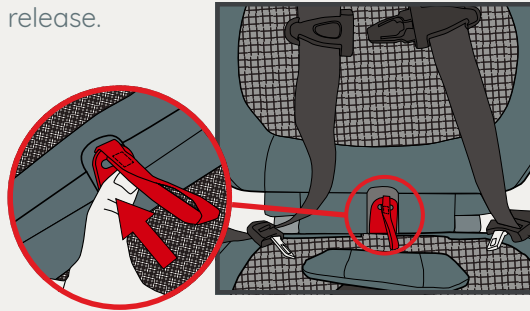

4. Adjust headrest into correct use position.

NOTE: See second step in the “Securing Child in Pico” section for assistance on headrest adjustment (pg. 35).

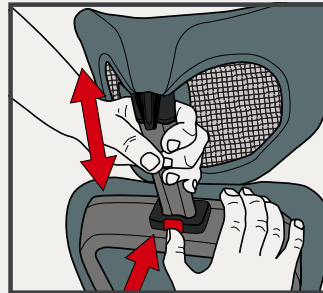

TWO WAYS TO SECURE PICO

This car seat can be secured to a vehicle using the LATCH System or a vehicle seat belt. WAYB recommends installing with the LATCH System whenever possible as the LATCH system generally allows for easiest installation.

LATCH SYSTEM

LATCH stands for Lower Anchors and Tethers for Children.

Most model year 2002 and newer vehicles are equipped with LATCH Anchorage Systems. Check vehicle owner’s manual to determine if your vehicle has the LATCH Anchorage System. Look for one of the below symbols:



LATCH system symbol

-or-



LATCH Lower Anchor symbol

-or-

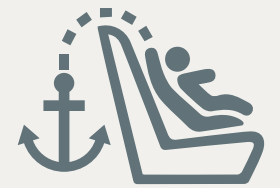

Tether Anchor symbol

Some vehicle owner’s manuals may identify the LATCH System as “ISOFIX”. An ISOFIX System can be used in the same way as the LATCH System.

Tether MUST always be used when available and installed with lower anchors of the LATCH system.



VEHICLE SEAT BELT AND TETHER

If your vehicle does not have the LATCH System, the car seat **MUST** be secured to the vehicle using a vehicle seat belt and tether strap if tether anchor is available. Check vehicle owner's manual for seating locations recommended for car seat use and location of tether anchorages.

Tether MUST always be used when a tether anchor is available.

TETHER INFORMATION

If a tether anchor is not available in your vehicle, the car seat **MUST** be secured with only the vehicle seat belt until a tether anchor can be installed.

For those vehicles where tether anchors are not available, the car seat may be used without the tether, provided a secure installation can be achieved.

When not in use, store tether in storage area at top of seat back.

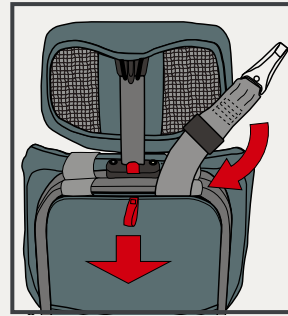

FOLDING PICO FOR TRANSPORT OR STORAGE

1. Adjust headrest all the way down into stored position.

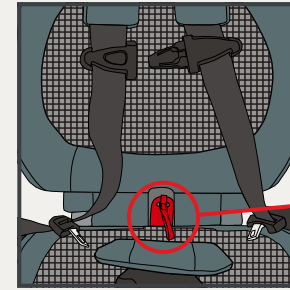
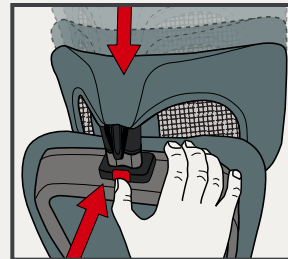

2. Release fold lock.

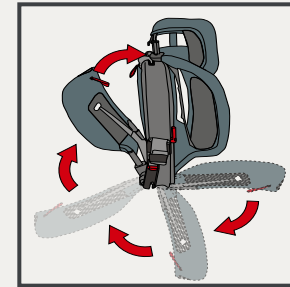
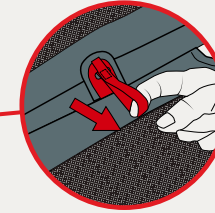

3. Rotate seat bottom to stored position.

NOTE: It may be necessary to unbuckle and loosen harness to allow seat bottom to rotate to stored position.

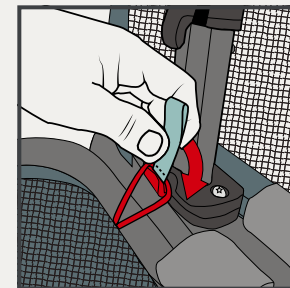

4. Hook fold retention loop onto hook at top of seat back.



Check out support videos at www.wayb.com/pages/support. Point your smartphone's camera directly at the QR Code to activate.



LATCH INSTALLATION

WAYB strongly recommends installing the Pico with LATCH whenever it is possible to correctly install with LATCH. The LATCH system generally allows for the easiest installation.

⚠ WARNING ⚠

- LATCH belt **MUST** stay tightly adjusted at all times.
- Tether **MUST** always be used with lower anchor belt when available.
- Only use the car seat LATCH System in vehicle seating locations designated by the vehicle manufacturer for use with LATCH and that have an anchor spacing between 11 in. and 20 in. (280 mm and 508 mm). Check your vehicle owner’s manual to see if your vehicle allows for non-standard, other than 11 in. (280 mm), lower anchor spacing.
- Lower anchor belts can be used to attach this car seat when restraining ALL children whom meet requirements in the “Who Can Use It” section of this manual (pg. 2).
- LATCH connectors **MUST** be secured to the vehicle LATCH anchors only. Connection to other vehicle anchors or vehicle components could result in the connector tearing free in a crash.
- NEVER attach more than one connector to a vehicle lower anchor unless recommended by the vehicle owner’s manual for that vehicle.
- When installing car seat using LATCH in a seating position that has a lap and shoulder belt, ALWAYS buckle the lap and shoulder belt and lock the retractor or position the lap and shoulder belt out of the child’s reach to prevent entanglement.



Check out support videos at www.wayb.com/pages/support. Point your smartphone’s camera directly at the QR Code to activate.

1. Refer to vehicle owner’s manual to identify the seating locations with the LATCH Anchorage System. Select the seating location to be used and locate the vehicle lower anchors at the seat bight for that seating location. Location of some vehicle lower anchors will be identified by the LATCH Lower Anchor Symbol:

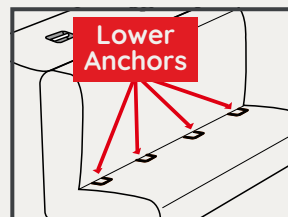

2. After selecting a seating location, if vehicle seat back is adjustable, adjust seat back into most upright position or the position specified in the vehicle owner’s manual.

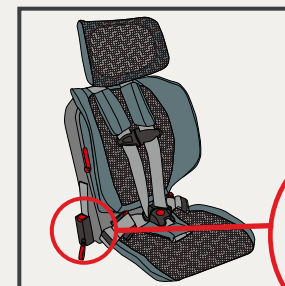

3. Set up Pico for use by unfolding and locking into use position, see “Setting Up Pico” section for assistance (pg. 17). Check that fold lock is securely engaged.

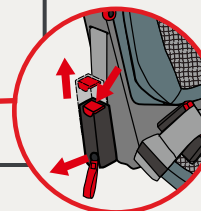

Remove push-on connectors from the storage bars on both sides of the car seat.

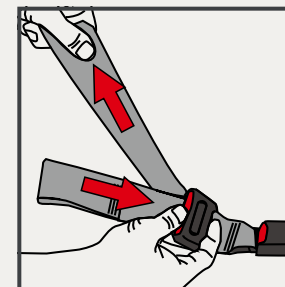

4. Lengthen lower anchor belt by pressing adjuster release button while pulling belt to extend the length of lower anchor belt.



5. Remove tether from storage compartment on back of car seat and place in seating area of car seat.

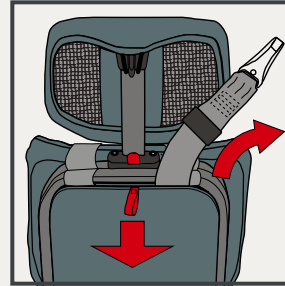

6. Place car seat forward-facing in the vehicle seat location selected with car seat centered between the vehicle lower anchors.



7. Connect lower anchor connectors to vehicle lower anchors.

- Position red release button of push-on connector facing away from car seat so that lower anchor belt is not twisted.
- Position the slot of the push-on connector onto the lower anchorage. Push connector in to lock onto the lower anchorage. You should hear a “click”.
- Pull on connector to be sure it is locked onto the anchorage.
- Repeat for connector on opposite side.

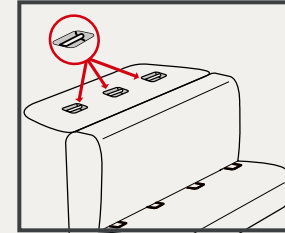
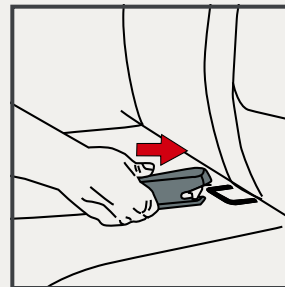

8. Locate the tether anchor for the seating location being used.

NOTE: Check vehicle owner’s manual for tether anchor locations and proper routing of tether strap in relation to vehicle headrest. **DO NOT** use cargo tie downs or other attachment points not intended for use with car seats. Look for the tether anchor symbol:

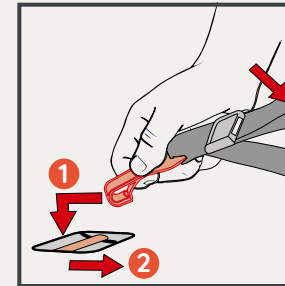

9. Attach tether hook **1** to vehicle tether anchor **2** and pull strap to remove slack from tether. Check that the tether strap is not twisted. Final tightening will occur in a later step.

NOTE: To lengthen the tether strap, push the tether adjuster button and pull the tether strap through the adjuster.

Tether MUST always be used when available.

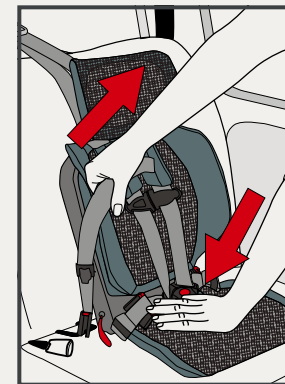

10. Tighten lower anchor belt to secure the car seat. Place your hand in center of car seat bottom and use leverage to compress the car seat into the vehicle cushion while tightening the lower anchor belt.

NOTE: Check that both sides of lower anchor belt are tight. It may be necessary to pull some strap through the seat back frame or to gently rock the seat back left to right while tightening.

11. Snugly adjust tether strap by pulling on free end.

NOTE: Check that both sides of the tether strap are tight. It may be necessary to pull some strap through the tether hook toward the adjuster.



12. Check for secure installation. Gripping car seat at the belt path, pull car seat front to back and left to right to check for secure installation. LATCH belt **MUST** stay tight. Car seat should not move more than 1 in. (25.4 mm).

If LATCH belt does not stay tight or car seat cannot be securely installed:

- Try a different LATCH equipped seating position.
- Try installing using the vehicle seat belt. See “Vehicle Seat Belt Installation” section (pg. 29).

⚠ WARNING ⚠

- DO NOT use this car seat if it cannot be securely installed.

⚠ WARNING ⚠

- DO NOT use the Pico in a vehicle seat that does not support at least 80% of the car seat bottom.

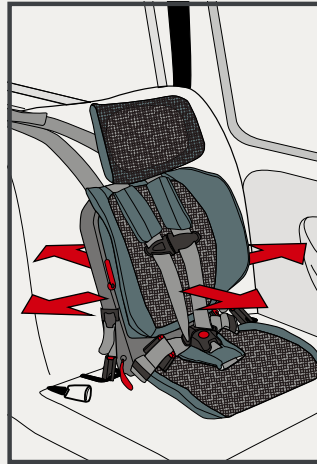

REMOVAL OF PICO INSTALLED WITH LATCH

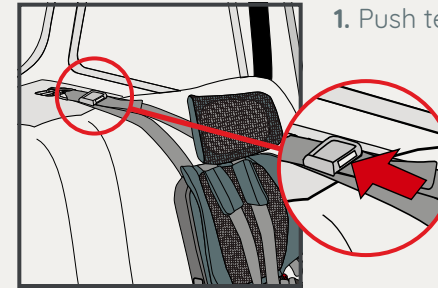

1. Push tether strap adjuster button to loosen tether strap.

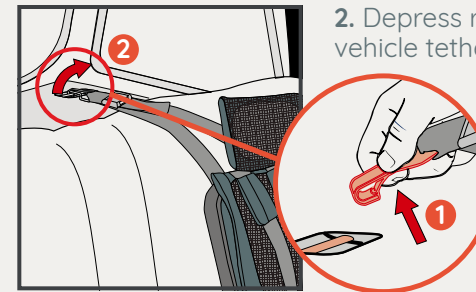

2. Depress retainer spring **1** and unhook tether hook **2** from vehicle tether anchor.

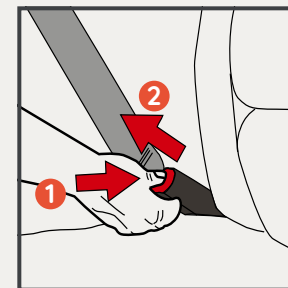

3. Loosen lower anchor belt by pressing adjuster button and pulling out lower anchor belt.

➤ Pressing down in center of car seat to reduce tension on lower anchor belt will make it easier to loosen lower anchor belt.

4. Remove push-on connectors from vehicle lower anchors.

➤ Press and hold the red release button **1**.

➤ Pull the connector off the lower anchorage **2**.

➤ Repeat to remove push-on connector on opposite side.



STORAGE OF LOWER ANCHOR BELT AND CONNECTORS

- When not using the LATCH System, store the lower anchor belt and push-on connectors on the LATCH storage bars on both sides of car seat.
- Pull the red loop on the push-on connector storage bar and push the connector onto the bar.

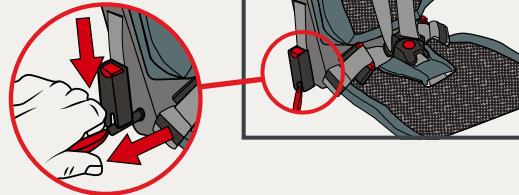

TETHER STORAGE

- Store tether **1** in storage pocket **2** on back of car seat.

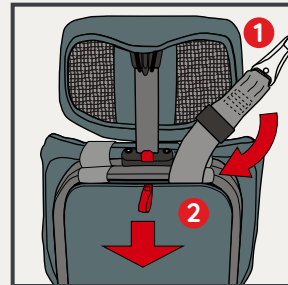

VEHICLE SEAT BELT INSTALLATION

⚠ WARNING ⚠

- Tether **MUST** always be used if vehicle tether anchor is available.
- Not all vehicle seat belts can be used with this car seat. Read vehicle owner’s manual and the “Vehicle Seat Belt System Overview” section in this manual (pg. 11).
- Vehicle seat belt **MUST** stay tightly adjusted around car seat at all times. If vehicle seat belt does not stay tight, read the vehicle owner’s manual and the “Vehicle Seat Belt System Overview” section in this manual (pg. 11).



Check out support videos at www.wayb.com/pages/support. Point your smartphone’s camera directly at the QR Code to activate.



1. Refer to vehicle owner’s manual to identify the seating locations which can be used with a car seat. Check for specific instructions for car seat use.
2. After selecting a seating location, if vehicle seat back is adjustable, adjust seat back into most upright position or the position specified in the vehicle owner’s manual.
3. Set Pico up for use by unfolding and locking into use position, see the “Setting Up Pico” section for assistance (pg. 17). Check that fold lock is securely engaged.

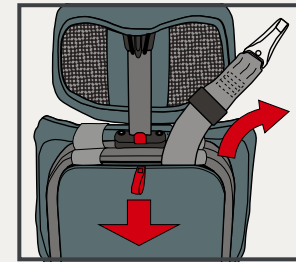

4. Remove tether from storage compartment on back of car seat and place in seating area of car seat.



5. Place car seat forward-facing in the vehicle seat location selected, centered between the vehicle belt anchors.

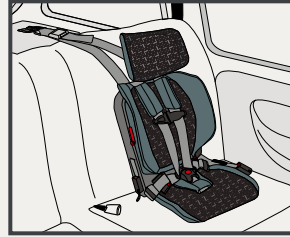

6. Route vehicle belt between the backrest and car seat frame. Place the vehicle lap belt or lap portion of a lap and shoulder belt into both vehicle belt guides on the front of the car seat frame, behind the backrest.

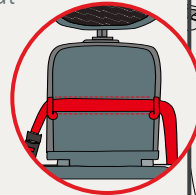

Lap belt **MUST** be through both belt guides.

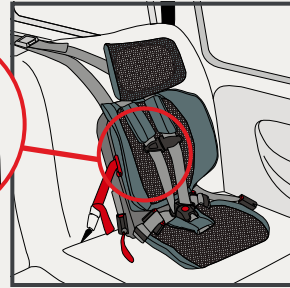

7. If your vehicle belt is equipped with a switchable retractor, switch it to locking mode.

NOTE: See the “Vehicle Seat Belt System Overview” section of this manual for assistance (pg. 11)

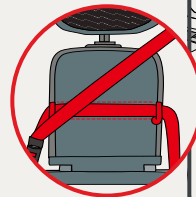

Shoulder belt **MUST NOT** be through either belt guide.

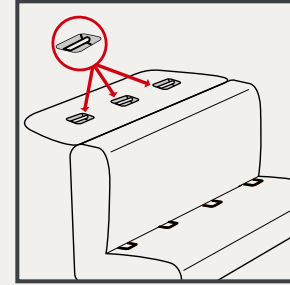
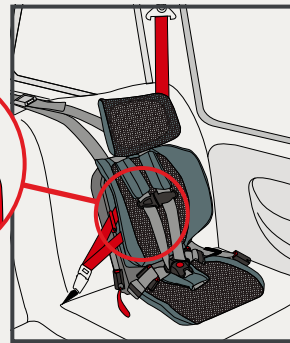

8. Locate the tether anchor for the seating location being used if available. If no tether anchor is available, skip next step.

NOTE: Check vehicle owner’s manual for tether anchor locations and proper routing of tether strap in relation to vehicle headrest. **DO NOT** use cargo taie downs or other attachment points not intended for use with car seats. Look for the tether anchor symbol:

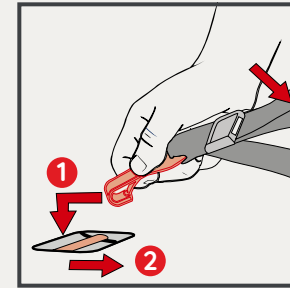

9. Attach tether hook **1** to vehicle tether anchor **2** and pull strap to remove slack from tether. Check that the tether strap is not twisted. Final tightening will occur in a later step.

NOTE: To lengthen the tether strap, push the tether adjuster button and pull the tether strap through the adjuster.

Tether MUST always be used when available.

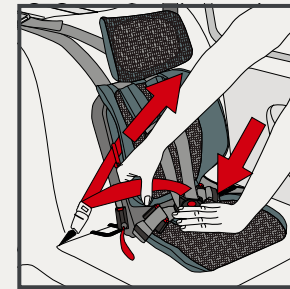

10. Tighten vehicle seat belt to secure the car seat.

FOR VEHICLE LAP BELT ONLY

Place your hand in center of car seat bottom and use leverage to compress the car seat into the vehicle cushion while tightening the vehicle lap belt.

NOTE: Rocking the car seat from side to side while tightening may assist in getting the lap belt tightly adjusted.



FOR VEHICLE LAP AND SHOULDER BELTS

Place your hand in center of car seat bottom and use leverage to compress the car seat into the vehicle cushion while pulling on the shoulder belt to tighten the vehicle lap belt. Rocking the car seat from side to side will assist in getting the lap belt tightly adjusted.

NOTE: If your vehicle belt is not equipped with a switchable retractor or locking LATCH plate, you may need a locking clip to securely install this car seat. Contact WAYB at **1-888-924-WAYB** (9292) or email help@wayb.com to request a free locking clip.

If using tether, snugly adjust tether strap by pulling on free end.

NOTE: Check that both sides of the tether are tight. It may be necessary to pull some strap through the tether hook toward the adjuster to get both sides tight.

Check for secure installation. Gripping car seat at the belt path, pull car seat front to back and left to right to check for secure installation. Car seat should not move more than 1 in. (25.4 mm). Vehicle lap belt **MUST** stay tight.

If vehicle lap belt does not stay tight or car seat cannot be securely installed:

- Try installing with LATCH. See “LATCH Installation” section (pg. 22).
- Try installing in a different vehicle seating position.

⚠ WARNING ⚠

- DO NOT use this car seat if it cannot be securely installed.

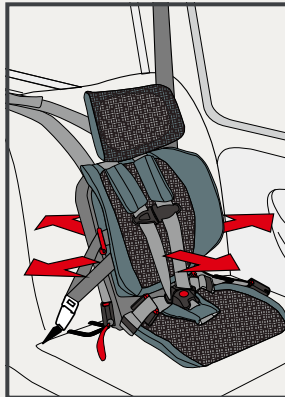
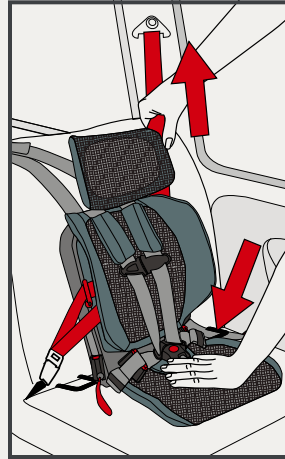

⚠ WARNING ⚠

- DO NOT use the Pico in a vehicle seat that does not support at least 80% of the car seat bottom.

REMOVAL OF PICO INSTALLED WITH VEHICLE SEAT BELT

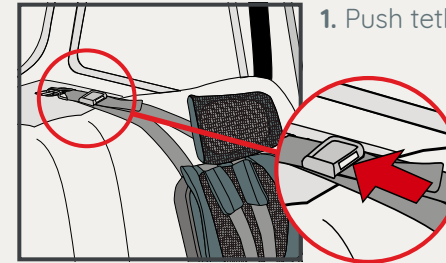

1. Push tether strap adjuster button to loosen tether strap.

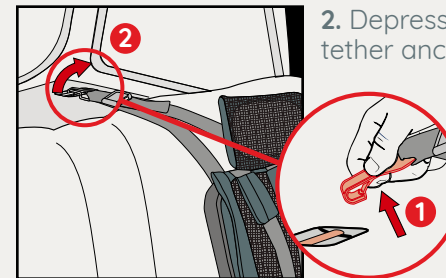

2. Depress retainer spring 1 and unhook tether hook 2 from vehicle tether anchor.

Unbuckle vehicle seat belt. Pressing down in center of car seat to reduce tension on vehicle seat belt will make it easier to unbuckle vehicle seat belt.



TETHER STORAGE

➤ Store tether **1** in storage pocket **2** on back of car seat.

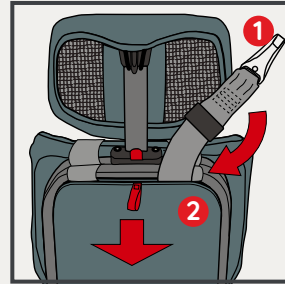

AIRCRAFT INSTALLATION



This restraint is Certified for Use in Motor Vehicles and Aircraft. Contact airline about their policy on use of child restraints on their aircraft. Use this car seat only on forward-facing aircraft seats.

For proper installation in an aircraft, follow lap belt only instructions from the “Vehicle Seat Belt Installation” section of this manual (pg. 29).

BELT ROUTING

➤ Lap belt **MUST** be routed through both belt guides.

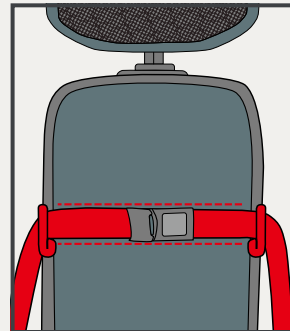

Check out support videos at www.wayb.com/pages/support. Point your smartphone's camera directly at the QR Code to activate.

SECURING CHILD IN PICO

⚠ WARNING ⚠

- Bottom of headrest **MUST** be above top of Pico seat back before use.
- Top of child’s ears **MUST** be below top of Pico headrest.
- Child’s shoulders **MUST** be below top of Pico seat back.
- Children **MUST** be more than 1 year of age and at least 22 lbs. (10 kg). WAYB recommends children be at least 2 years of age before using this forward-facing car seat.
- Keep harness straps snug and positioned on shoulders and thighs.
- Discontinue use of car seat if child’s shoulders are above top of seat back or top of ears are above top of headrest in its highest use position or child’s weight exceeds 50 lbs. (22.7 kg).
- Child **MUST** be dressed in clothing with arms and legs that will not interfere with buckling and snugly adjusting harness.
- **DO NOT** use accessories or parts other than those approved by WAYB. Use of unapproved accessories or parts could degrade the performance of the car seat. Go to the FAQ section of wayb.com to find approved list of accessories.
- **NEVER** leave child unattended, even when sleeping. Vehicle interiors can very quickly get hot enough to cause severe injury or death, even when it is not hot outside.
- **Strangulation Hazard:** Child can strangle in loose harness straps. **NEVER** leave child in car seat when straps are loose or not fully secured with the chest clip and buckle buckled.



Check out support videos at www.wayb.com/pages/support. Point your smartphone's camera directly at the QR Code to activate.

1. Check that fold lock is locked.

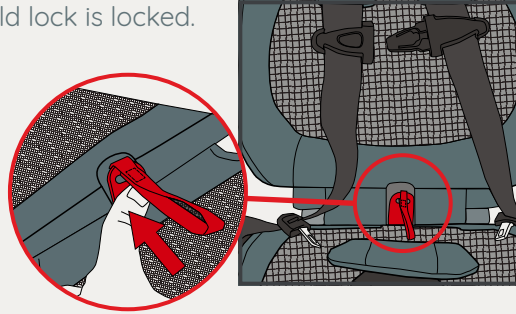

2. Position headrest in the correct use position for child. Push the headrest adjustment button as shown and move the headrest to a position where:

- Bottom of headrest is above top of seat back.
- Top of child's ears are below top of headrest.
- Check that child's shoulders are below top of seat back.

NOTE: Child's ears may be positioned below bottom of headrest adjusted into its lowest use position.

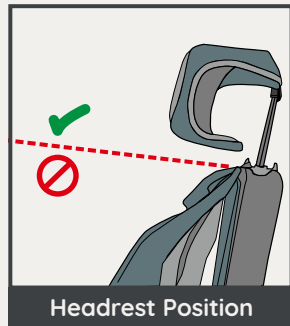
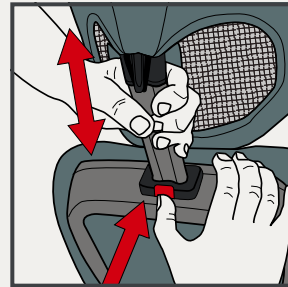

Headrest Position

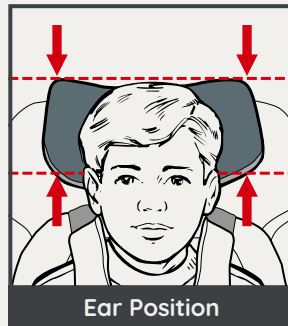

Ear Position

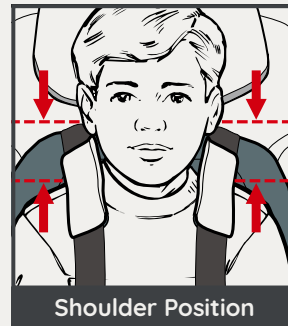

Shoulder Position

3. Unbuckle harness and place buckle tongues on sides of seat.

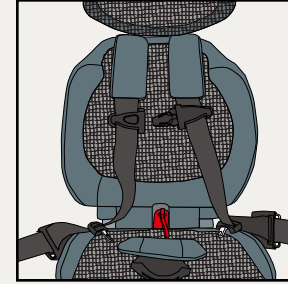

4. Place child in car seat with back and bottom contacting seat back and seat bottom surfaces.

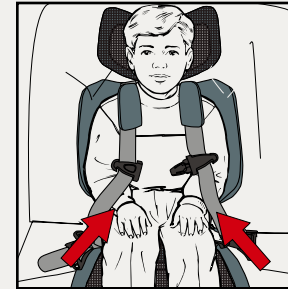

5. Position harness straps over child's shoulders and thighs and buckle harness:

- Insert buckle tongues into buckle one at a time. You should hear a "click" for each buckle tongue.
- Pull up on tongues to be sure they are locked.

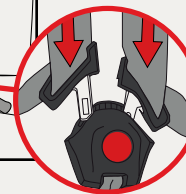



6. Pull free ends of harness straps to snugly adjust harness straps so that shoulder belt webbing cannot be pinched with fingers to fold webbing:

- Check that harness straps are snug on shoulders and thighs.
- A snug strap should not allow any slack. It lies in a relatively straight line without sagging. It does not press on the child's flesh or push the child's body into an unnatural position.

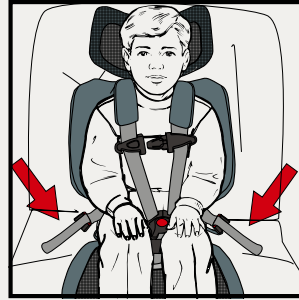

⚠ WARNING ⚠

• If harness cannot be snugly adjusted as described above, DO NOT use this car seat.

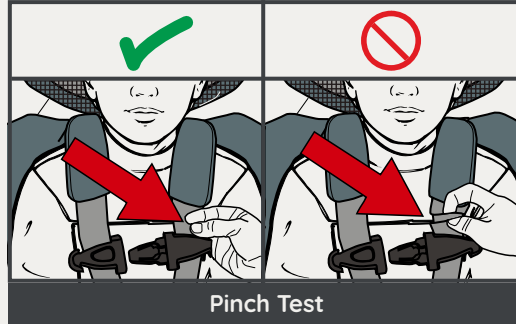

Pinch Test

7. Buckle chest clip and position chest clip at armpit level.

NOTE: When attached, shoulder strap pads **MUST** sit on top of child's shoulders.

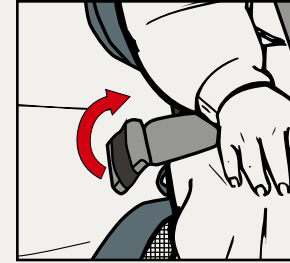
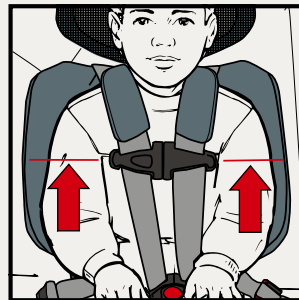

8. Roll both harness strap ends up and secure with the webbing loops.

REMOVAL OF CHILD FROM PICO

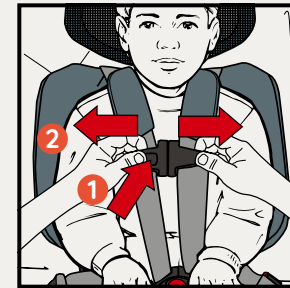

1. Press release button **1** and pull apart **2**.

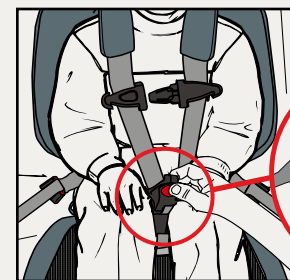

2. Release buckle by pressing red button **1** and pulling tongues **2** out.



BUCKLE OPERATION

TO BUCKLE

- Insert tongue into buckle one at a time. You should hear a “click”.
- Pull up on tongues to be sure they are locked.

TO UNBUCKLE

- Press red buckle release button and pull buckle tongues out of buckle.

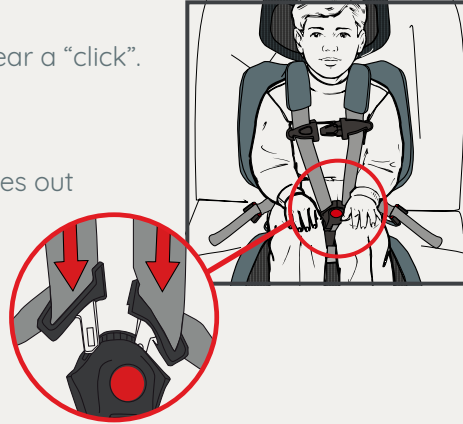

HARNESS STRAP ADJUSTMENT

⚠ WARNING ⚠

- **Harness MUST be fully secured and snugly adjusted around child.**

1. Pull free ends of harness straps to snugly adjust harness straps so that shoulder belt webbing cannot be pinched with fingers to fold webbing:

- Check that harness straps are snug on shoulders and thighs.
- A snug strap should not allow any slack. It lies in a relatively straight line without sagging. It does not press on the child’s flesh or push the child’s body into an unnatural position.

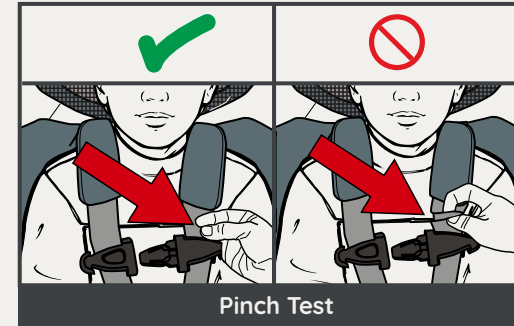
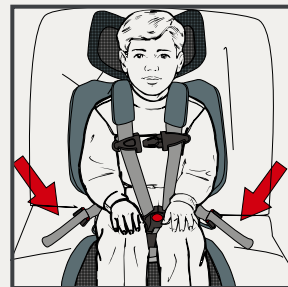

⚠ WARNING ⚠

- If harness cannot be snugly adjusted as described above, **DO NOT** use this car seat.

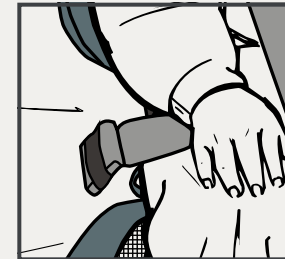

2. Roll both harness strap ends up and secure with the webbing loops.

CHEST CLIP OPERATION

TO OPEN

- Press release button **1** and pull apart **2**.

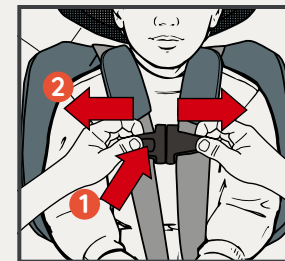



TO CLOSE

- Snap halves together.
- Make sure chest clip is locked by pulling on each half.
- Position chest clip at armpit level.

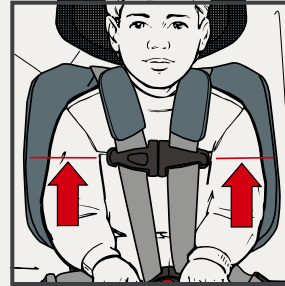

SHOULDER PAD REMOVAL AND INSTALLATION

TO REMOVE

- Pull hook and loop strips apart on sides of shoulder strap covers and remove off of the harness straps.

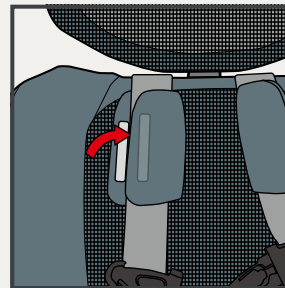

TO ATTACH

- Place shoulder strap covers over the harness straps and press hook and loop strips together.

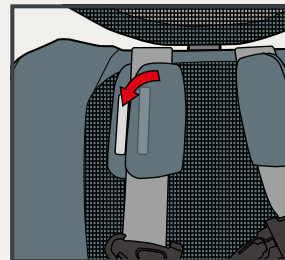

HEADREST ADJUSTMENT

TO ADJUST

- Press button **1** on back of headrest base and move headrest **2** up or down to desired position.

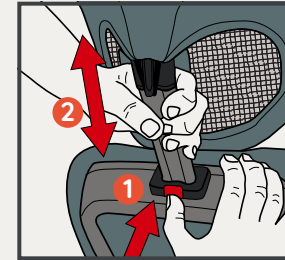

CARE AND CLEANING

FABRIC PADS (ALL Seat Pads, Buckle Pads and Shoulder Strap Pads)

- Recommend spot clean using warm water with mild, wool safe labeled detergent when feasible.
- Can remove fabric pads and hand wash using warm water and mild, wool safe labeled detergent. Dry flat and away from direct sunlight before re-use or storage. **DO NOT** bleach, iron, or machine wash.

NOTE: If needed, visit www.wayb.com to order replacement fabric pads.

HARNES STRAPS

- Spot clean using cold water with mild detergent. Air dry completely before re-use or storage. **DO NOT** bleach or dry clean.

ALUMINUM

- Spot clean using warm water. Towel dry completely before re-use or storage. **DO NOT** use detergents or lubricants. **DO NOT** remove labels from this car seat as they are meant to remind you and others of important information.

BUCKLE AND LOWER ANCHOR CONNECTOR HARDWARE

- Buckle should fasten with a “click”, if not, rinse under warm running water. **DO NOT** use detergents or lubricants.



FABRIC PAD REMOVAL AND INSTALLATION

⚠ WARNING ⚠

- NEVER use your Pico without ALL fabric pads in place.
- Pay careful attention to how fabric pads are attached during removal to allow correct assembly.

HEADREST FABRIC PAD REMOVAL

1. Adjust headrest to a convenient location above the seat back.

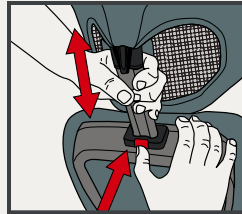

2. Pull the bottom edge of the headrest fabric down over headrest frame, then forward and up around until it can be released from the retention hook at the top of the headrest adjustment post.

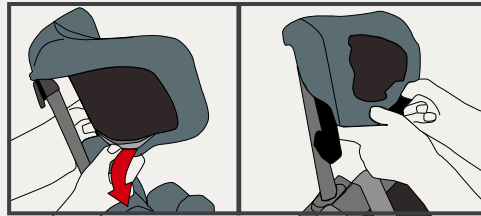

⚠ WARNING ⚠

- NEVER use this car seat without the rigid back panel in the headrest. This panel may be spot cleaned with warm water and a mild detergent, not laundered.

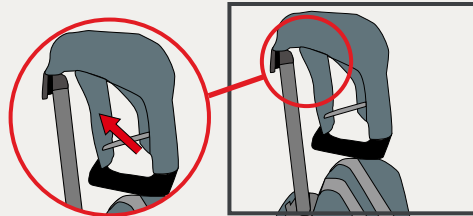

HEADREST FABRIC PAD INSTALLATION

Reverse the removal procedure to install the headrest pad.

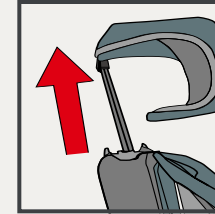

SEAT BACK FABRIC PAD REMOVAL

1. With the seat bottom secured in the stored position raise the headrest all the way up.

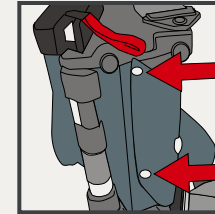

2. Locate and release the two snaps on the inside bottom of the seat back.

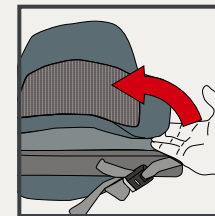

3. Lift bottom of seat back to access fabric fastener straps for top of seat back.

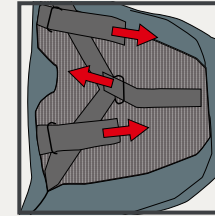

4. Release the fabric fastener at the top of the seat back and in the strap at the center of the seat back.

5. Pull fabric over top of seat back frame and remove from frame.

SEAT BACK FABRIC PAD INSTALLATION

Reverse the removal procedure to install the seat back pad.



Check out support videos at www.wayb.com/pages/support. Point your smartphone's camera directly at the QR Code to activate.



SEAT BOTTOM FABRIC PAD REMOVAL

1. Release the seat bottom from its use or stored position and place the Pico face down on a flat, clean surface.
2. Pull the buckle pad **1** and buckle **2** out of the seat bottom fabric pad.
3. Release all three fabric fastener straps on the seat bottom.
4. Pull the two hook and loop straps at the back of the seat bottom through the frame. Then pull them forward to remove the fabric pad from the frame.

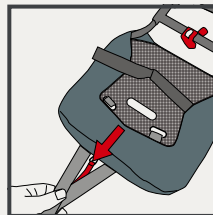
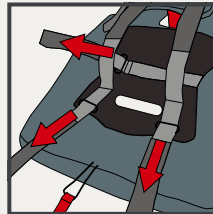
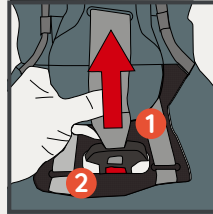
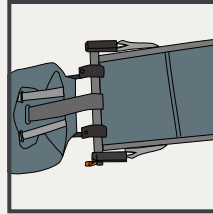

SEAT BOTTOM FABRIC PAD INSTALLATION

Reverse the removal procedure to install the seat bottom pad.

CAR SEAT USE AFTER A CRASH

⚠ WARNING ⚠

- **DO NOT** allow any use of this car seat after a crash unless crash and car seat meet **ALL** conditions stated below.

Car seats are damaged in vehicle crashes and in many cases, the car seat **MUST** be destroyed and replaced. However, the National Highway Traffic Safety Administration (NHTSA) advises that if a child restraint (car seat) has been used in a minor crash that the child restraint can continue to be used.

NHTSA defines a minor crash, which a car seat can continue to be used after, as a crash where **ALL** of the following apply:

- The vehicle was able to be driven away from the crash site.
- The vehicle door nearest the car seat was not damaged.
- None of the passengers in the vehicle sustained any injuries in the crash.
- If the vehicle has air bags, the air bags did not deploy during the crash, and
- There is no visible damage to the car seat.

Damage to car seats may be difficult to see or it may be difficult to verify the damage to the car seat. For those situations where any of the NHTSA Child Restraint Re-use criteria has not been met, or if there is uncertainty whether damage to the seat has occurred, NHTSA and WAYB advise parents or caregivers to replace their car seat.

DO NOT risk your child's safety.

Contact your insurance company for information on their policy regarding car seat replacement after a crash.

Please contact WAYB at help@wayb.com or call **1-888-924-WAYB** (9292) if you've been in a crash with your Pico.



BREATHE EASY GUARANTEE



We're making family adventures better, starting with our super-strong gear. Our gear is covered by a **3 YEAR** limited warranty, starting from the day it was purchased. Please complete your product registration and read our general warranty for more information on www.wayb.com. For returns, please consult our returns policy on www.wayb.com.

View full warranty policy at www.wayb.com/pages/warranty.
Point your smartphone's camera directly at the QR Code to activate.

SPECIFICS

- If for some reason our gear shows a defect in materials or workmanship during the warranty period, and such defect is discovered during the warranty period, we will, at our discretion, repair or replace your product at no cost to you. If we are unable to remedy defects, we will replace or issue a refund equal to the purchase price.
- In no event will WAYB or any of its retailers, dealers, distributors or resellers be liable for incidental, indirect, or consequential damages relating to the product (including any repaired or replacement product or component) or its use. Some states do not allow the exclusion or limitation of incidental or consequential damages, so the above limitation and exclusion may not apply to you.
- Please note that this warranty extends to all purchases from www.wayb.com and if purchased new from an authorized retailer. Warranty is terminated when original purchaser sells or transfers product to another person.

WHAT IS NOT COVERED

- Normal wear/tear or cosmetic damages: scratches, dents, tears, natural breakdown of colors and materials over time, commercial use, crashes, unlawful vehicle operation, negligence, sun intensity, sweat, detergents, damp storage, frequent washings, or failing to comply with the instruction manual or modifications/repairs not performed or authorized by WAYB.

- If the service to be provided is not covered by the warranty, we will ask you to cover the costs.
- Incorrect or inappropriate usage, including but not limited to: installation, care, maintenance, storage and cleaning that does not follow the instructions in our manuals.
- Casualties and carelessness including those caused by both unsuitable parts or by air or freight transportation.
- Personal opinion dissatisfaction pertaining to functionality, features or aesthetics.

START THE PROCESS

To make a claim, please contact us by email at help@wayb.com or call WAYB customer experience team at **1-888-924-WAYB** (9292).

- Provide your proof of purchase, model number, serial number, details of the issue, how it was being used, and photos that clearly show the issue.
- If WAYB determines that the repair is under warranty:
 - WAYB will provide a return authorization number, shipping instructions and pre-paid return label.
 - WAYB will cover costs associated with standard shipping in the USA and handling, and repair or replace within 60 days of receiving.

THIS LIMITED WARRANTY IS EXCLUSIVE AND IN LIEU OF ANY OTHER WARRANTY, WRITTEN OR ORAL, INCLUDING BUT NOT LIMITED TO ANY EXPRESS WARRANTY OF MERCHANTABILITY OR FITNESS FOR A PARTICULAR PURPOSE. THE DURATION OF ANY IMPLIED WARRANTIES, INCLUDING ANY IMPLIED WARRANTY OF MERCHANTABILITY OR FITNESS FOR A PARTICULAR PURPOSE, IS EXPRESSLY LIMITED TO THIS LIMITED WARRANTY PERIOD.

Some states do not allow limitations on how long an implied warranty lasts; therefore, the above limitations and exclusions may not apply to you.

PicoTM
Forward-Facing Car Seat



WAYB

99 Pasadena Avenue, Suite 11
South Pasadena, CA 91030

help@wayb.com



PPCS020 121018